

## Mod. S6430 - Series 6000 fittings

Product code: S6430 10-3/8

Datasheet creation date: 19/05/2026 18:20

Check the most updated document online [click here](#)



### ■ TECHNICAL DATA

|      |              |
|------|--------------|
| Mod. | S6430 10-3/8 |
|------|--------------|

## Mod. S6430 - Series 6000 fittings

Product code: S6430 10-3/8

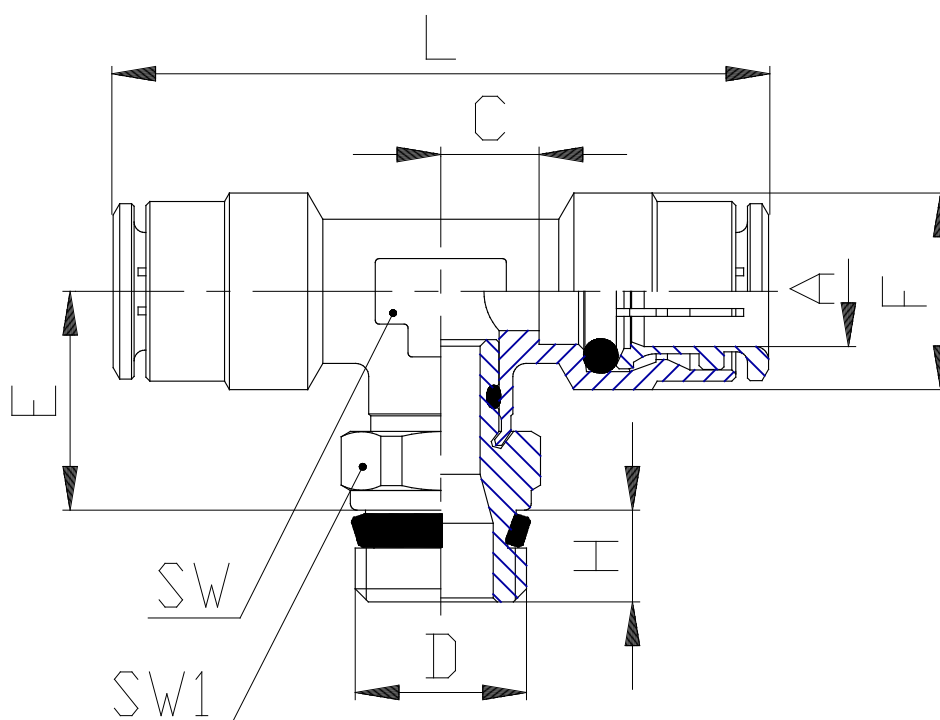

### DIMENSIONS

|                 |      |
|-----------------|------|
| <b>A (mm)</b>   | 10   |
| <b>D</b>        | G3/8 |
| <b>C (mm)</b>   | 6.5  |
| <b>E (mm)</b>   | 19.0 |
| <b>F (mm)</b>   | 16.5 |
| <b>H (mm)</b>   | 8.0  |
| <b>L (mm)</b>   | 53   |
| <b>SW (mm)</b>  | 13   |
| <b>SW1 (mm)</b> | 19   |