

## Single sub-base with rear outlets (VDMA 24345) - Series 9

Product code: 903-G3A

Datasheet creation date: 20/05/2026 02:06

Check the most updated document online [click here](#)



### TECHNICAL DATA

|             |         |
|-------------|---------|
| <b>Mod.</b> | 903-G3A |
| <b>Size</b> | 3       |

## Single sub-base with rear outlets (VDMA 24345) - Series 9

Product code: 903-G3A

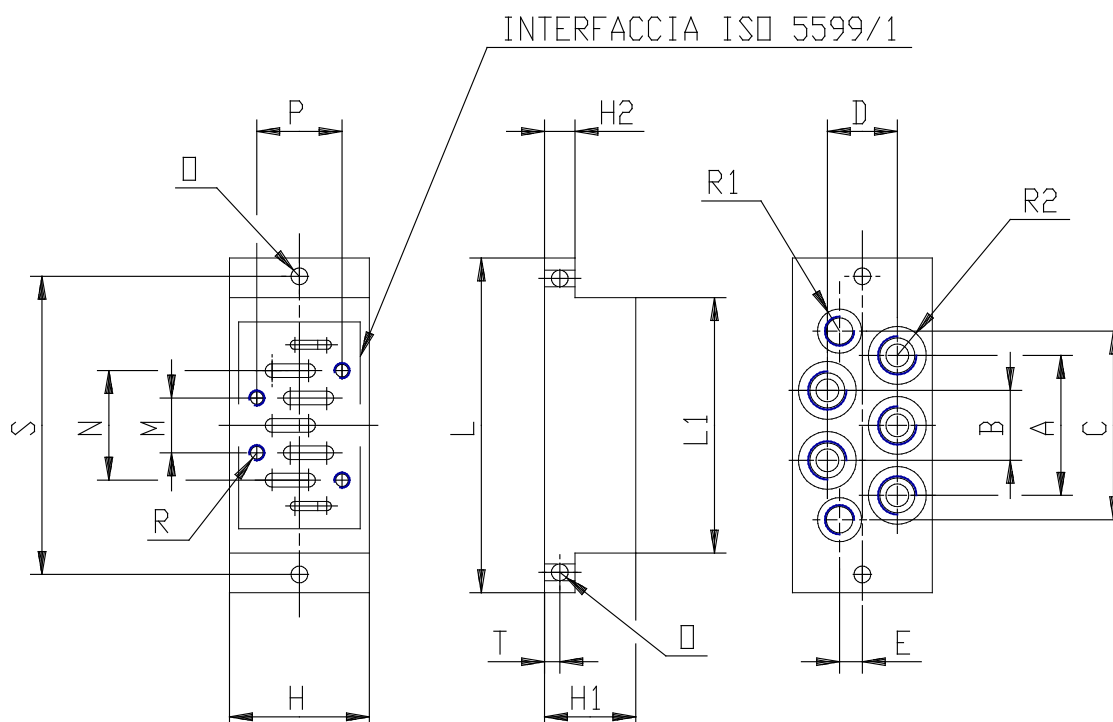

### DIMENSIONS

|      |      |
|------|------|
| (mm) | 68   |
| (mm) | 34   |
| (mm) | 90   |
| (mm) | 34   |
| (mm) | 10.0 |
| (mm) | 71   |
| (mm) | 32   |
| (mm) | 18   |
| (mm) | 149  |
| (mm) | 119  |
| (mm) | 6.5  |
|      | G1/8 |
|      | G1/2 |
| (mm) | 136  |