

## 3/2-way solenoid valve - Mod. 638/648

Product code: 638-150-A6E

Datasheet creation date: 19/05/2026 08:47

Check the most updated document online [click here](#)



### TECHNICAL DATA

|                |                            |
|----------------|----------------------------|
| <b>Cod.</b>    | 638-150-A6                 |
| <b>Voltage</b> | E = 230 V 50/60 Hz - 12 VA |
| <b>Version</b> | = Standard                 |

## 3/2-way solenoid valve - Mod. 638/648

Product code: 638-150-A6E

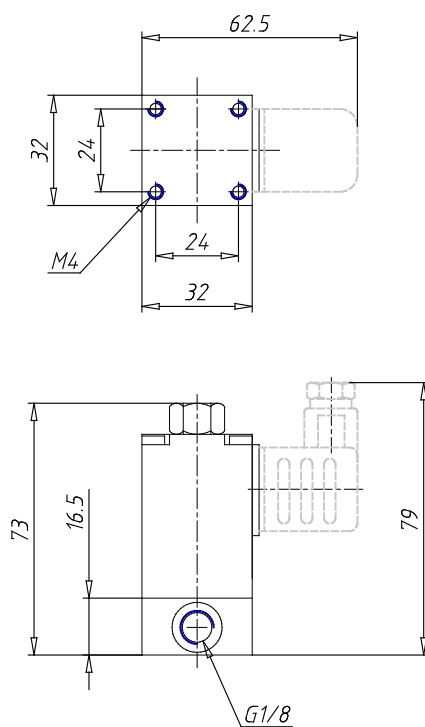

### DIMENSIONS

|                               |          |
|-------------------------------|----------|
| <b>Thread port</b>            | G1/8     |
| <b>Function</b>               | 3/2 N.C. |
| <b>Orifice (Ø mm)</b>         | 2        |
| <b>Qn (Nl/mm)</b>             | 130      |
| <b>Pressure min-max (bar)</b> | 0÷10     |