

Cylinders - aluminium profile ISO 15552 (ex DIN/ISO 6431 / VDMA 24562) - Series 61

Product code: 61M2P050A0125

Datasheet creation date: 19/05/2026 08:58

Check the most updated document online [click here](#)



TECHNICAL DATA

| | |
|---------------------------|---|
| Series | 61 |
| Diameter (mm) | 50 |
| Version | M = magnetic standard |
| Operation | 2=double acting (front and rear cushioning) |
| Materials | P = standard: AL end-blocks and piston, rolled stainless steel AISI 420B rod, anodized AL profile tube, zinc-plated steel tie-rods and tie-rod nuts, PU seals |
| Construction | A = standard with lock nut for rod |
| Stroke type | = standard |
| Stroke (mm) | 125 |
| Seal options | = standard |
| Rod length (mm) | 0 |
| (mm) | 0 |
| Protection options | = standard |
| Certifications | = standard |

Cylinders - aluminium profile ISO 15552 (ex DIN/ISO 6431 / VDMA 24562) - Series 61

Product code: 61M2P050A0125

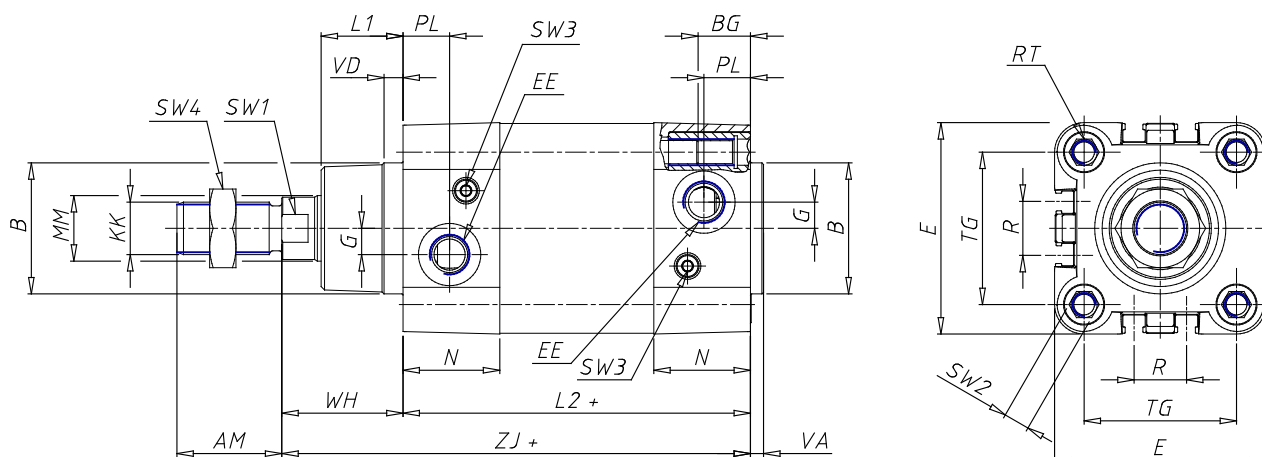

DIMENSIONS

| | |
|------------|---------|
| MM (mm) | 20 |
| KK | M16x1,5 |
| B d11 (mm) | 40 |
| PL (mm) | 15 |
| L1 (mm) | 25 |
| L11 (mm) | 25 |
| L12 (mm) | 82 |
| AM (mm) | 32 |
| VA (mm) | 4 |
| VAX (mm) | 4 |
| EE | G1/4 |
| WH (mm) | 37 |
| L2 (mm) | 106.0 |
| ZM (mm) | - |
| ZJ (mm) | 143 |
| ZMX (mm) | 180 |
| ZJX (mm) | 143 |
| VD (mm) | 6 |
| N (mm) | 29.5 |
| BG (mm) | 16.0 |
| RT | M8 |
| TG (mm) | 46.5 |
| G (mm) | 8.0 |

| | |
|-----------------------------|-------|
| R (mm) | 16.0 |
| E (mm) | 64.5 |
| SW1 (mm) | 17 |
| SW2 (mm) | 8 |
| SW3 (mm) | 3 |
| SW4 (mm) | 24 |
| Cushion stroke front spring | 15 |
| Cushion stroke rear spring | 14 |
| L3 (mm) | 225.0 |
| L4 (mm) | 15 |
| L5 (mm) | 16 |
| L6 (mm) | 29.5 |
| L7 (mm) | 48.0 |
| L8 (mm) | 60 |
| L9 (mm) | 106.0 |
| ø D (mm) | 20 |
| ø D1 d11 (mm) | 40.0 |
| ø D2 (mm) | 50 |
| ø D3 f6 (mm) | 35 |
| ± 0.15 (mm) | 46.5 |
| GX | G1/8 |
| H (mm) | 36.0 |
| H1 (mm) | 64.0 |