

5/2-way valve, G3/8 port, monostable - Series 4

Product code: 453-35

Datasheet creation date: 19/05/2026 17:05

Check the most updated document online [click here](#)



TECHNICAL DATA

Mod.	453-35
Mounting	in-line/on manifold
Function	5/2
Flow rate (Nl/min)	1800
Min. pilot pressure (bar)	2,5
Operating pressure (bar)	-0,9-10

5/2-way valve, G3/8 port, monostable - Series 4

Product code: 453-35

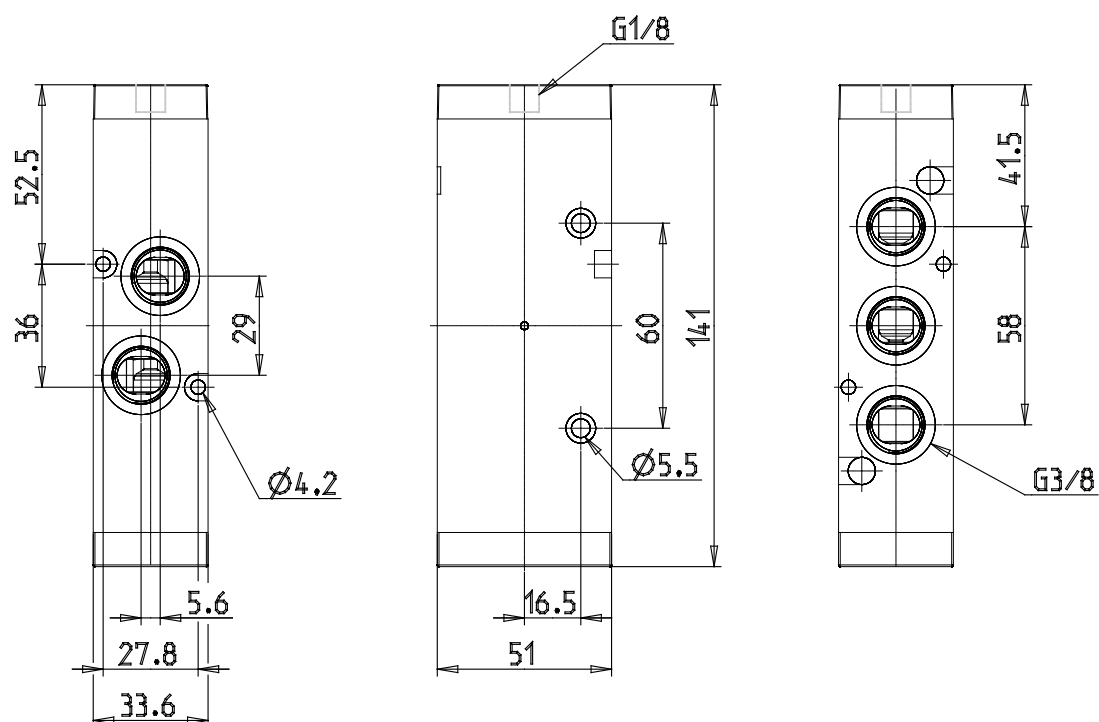

DIMENSIONS

Mod.	453-35
Mounting	in-line/on manifold
Function	5/2
Flow rate (NI/min)	1800
Min. pilot pressure (bar)	2,5
Operating pressure (bar)	-0,9-10