

Mechanically operated valves - Series 1 and 3 / 138-945

Product code: 138-945

Datasheet creation date: 19/05/2026 08:50

Check the most updated document online [click here](#)



TECHNICAL DATA

| | |
|---------------------------------|-------------------|
| Mod. | 138-945 |
| Operating pressure (bar) | 0÷10 bar |
| Flow rate | 500NL/min |
| Actuating force | 70N |
| Activity | Actuating plunger |

Mechanically operated valves - Series 1 and 3 / 138-945

Product code: 138-945

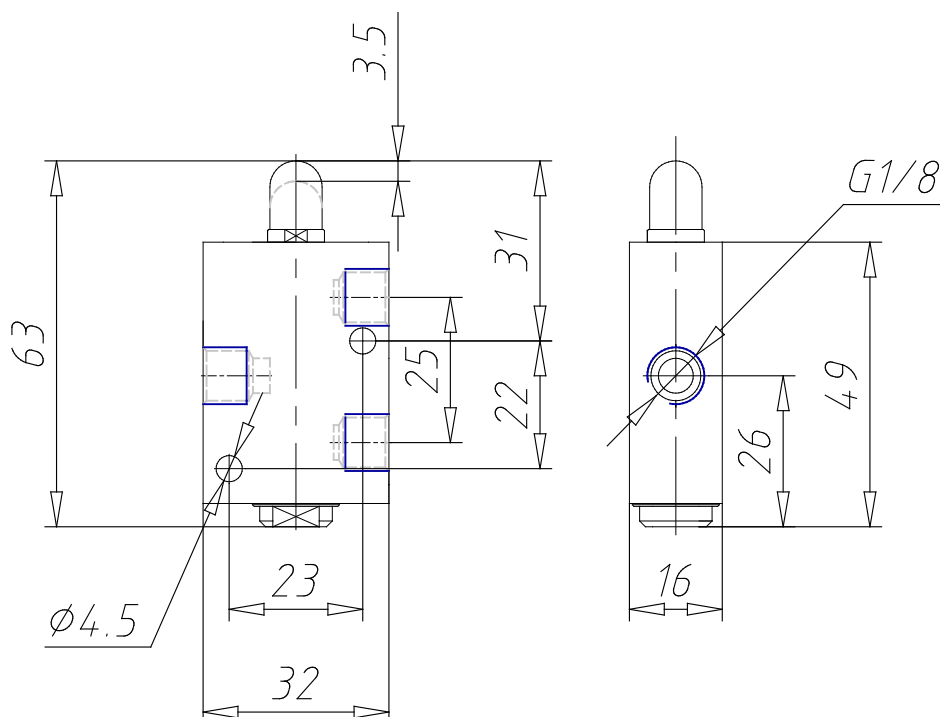

DIMENSIONS

| | |
|---------------------------------|-------------------|
| Mod. | 138-945 |
| Operating pressure (bar) | 0÷10 bar |
| Flow rate | 500NL/min |
| Actuating force | 70N |
| Activity | Actuating plunger |