

Brass with a bare metal surface

One-hand quick disconnect couplings, one side sealing, extremely compact with a large bore and only a small pressure drop.

Ideal for:

Medical equipment, dental equipment, instrumentation and control, chemical applications, laboratory equipment, analysis techniques, miniature pneumatics, mechanical engineering.

Operating pressure:

0 to 35 bar, maximum static working pressure (non-pulsating)

Medium and ambient temperature:

-20 °C to +100 °C

Housing, sleeve and body:

Brass

Spring, retaining ring, balls:

Stainless steel

Sealant:

NBR

Flow rate (air):

165 l/min



243.08/2



243.08/4



243.08/6



243.08/8

Flow rates:

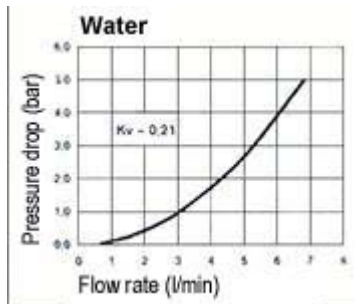
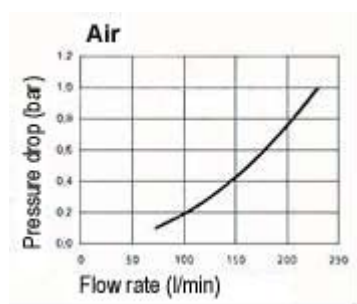

Quick disconnect couplings DN 2.7, brass with a bare metal surface, male

Art. No.	Ident No.	Connection	a/f mm	L mm	D mm	L1 mm	L2 mm	G mm
243.08/1	107069	M5 male	9	26.0	10.0	5.0	-	-
243.08/2	107070	G 1/8 male	11	28.0	10.0	7.0	-	-

Quick disconnect couplings DN 2.7, brass with a bare metal surface, female

Art. No.	Ident No.	Connection	a/f mm	L mm	D mm	L1 mm	L2 mm	G mm
243.08/3	107071	M5 female	9	25.0	10.0	5.0	-	-
243.08/4	107072	G 1/8 female	12	28.0	10.0	7.0	-	-

Quick disconnect couplings DN 2.7, brass with a bare metal surface, with hose stem

Art. No.	Ident No.	Connection	a/f mm	L mm	D mm	L1 mm	L2 mm	G mm
243.08/5	107073	Stem, I.D. 3	-	35.0	10.0	13.0	-	-
243.08/6	107074	Stem, I.D. 4	-	35.0	10.0	13.0	-	-

Quick disconnect couplings DN 2.7, brass with a bare metal surface, with hose connector

Art. No.	Ident No.	Connection	a/f mm	L mm	D mm	L1 mm	L2 mm	G mm
243.08/7	107075	Hose connection 4x3	9	34.0	10.0	7.0	5.0	M7x0,5
243.08/8	107076	Hose connection 5x3	9	34.0	10.0	7.0	5.0	M7x0,5
243.08/9	107077	Hose connection 6x4	9	34.0	10.0	7.0	5.0	M8x0,5

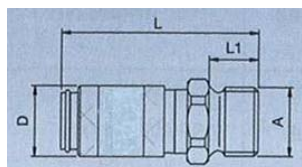

Male

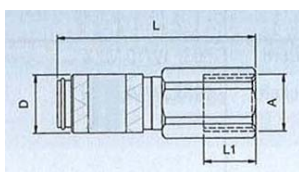

Female

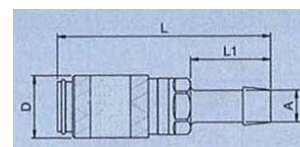

Hose connection

Plugs DN 2.7, brass with a bare metal surface, female

Art. No.	Ident No.	Connection	a/f mm	L mm	D mm	L1 mm	L2 mm	G mm
243.09/1	107078	Stem, I.D. 3	-	24.0	7.0	13.0	-	-
243.09/2	107079	Stem, I.D. 4	-	24.0	7.0	13.0	-	-

Plugs DN 2.7, brass with a bare metal surface, for hose

Art. No.	Ident No.	Connection	a/f mm	L mm	D mm	L1 mm	L2 mm	G mm
243.09/3	107080	Plug for hose 4x3	7	25.0	-	7.0	5.0	M7x0,5
243.09/4	107081	Plug for hose 5x3	7	25.0	-	7.0	5.0	M7x0,5
243.09/5	107082	Plug for hose 6x4	8	25.0	-	7.0	5.0	M8x0,5

Plugs DN 2.7, brass with a bare metal surface, male

Art. No.	Ident No.	Connection	a/f mm	L mm	D mm	L1 mm	L2 mm	G mm
243.09/6	107083	Plug, M5 male	7	18.0	-	5.0	-	-
243.09/7	107084	Plug, G 1/8 male	11	20.0	-	7.0	-	-

Plugs DN 2.7, brass with a bare metal surface, female

Art. No.	Ident No.	Connection	a/f mm	L mm	D mm	L1 mm	L2 mm	G mm
243.09/8	107085	Plug, M5 female	7	17.0	-	5.0	-	-
243.09/9	107086	Plug, G 1/8 female	12	19.0	-	7.0	-	-



243.09/2



243.09/5



243.09/7



243.09/9

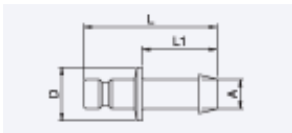

Stem

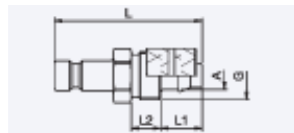

Plug for hose



Male

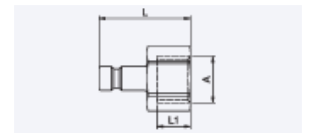

Female

Vibrating tool

With vibrating tool, the ISO 6150 (Pneumatic fluid power - Cylindrical quick-action couplings) recommends under § 7.1, that between this and a quick-connect coupling a min. 300 mm longer, more flexible hose should be installed. The oscillating forces are caught up by the hose piece and increase the service life of a quick-connect coupling. No warranty can be made for couplings mounted directly on vibrating tools.