

**Mechanical
pressure measurement**

Bourdon tube pressure gauge Model 213.40, liquid filling, forged brass case

WIKA data sheet PM 02.06



for further approvals
see page 2

Applications

- For measuring points with high dynamic pressure loads or vibrations
- For gaseous and liquid media that are not highly viscous or crystallising and will not attack copper alloy parts
- Mining
- Hydraulics
- Shipbuilding

Special features

- Vibration and shock resistant
- Especially robust design
- NS 63 and 100 with Germanischer Lloyd and Gosstandart approval
- Scale range up to 0 ... 1,000 bar



Bourdon tube pressure gauge model 213.40

Description

Design
EN 837-1

Nominal size in mm
63, 100

Accuracy class
NS 63, : 1.6
NS 100: 1.0

Scale ranges
0 ... 0.6 to 0 ... 1,000 bar
or all other equivalent vacuum or combined pressure and vacuum ranges

Pressure limitation

NS 63, 80:	Steady:	3/4 x full scale value
	Fluctuating:	2/3 x full scale value
	Short time:	Full scale value
NS 100:	Steady:	Full scale value
	Fluctuating:	0.9 x full scale value
	Short time:	1.3 x full scale value

Permissible temperature

Ambient: -20 ... +60 °C
Medium: +60 °C maximum

Temperature effect

When the temperature of the measuring system deviates from the reference temperature (+20 °C): max. $\pm 0.4 \%$ / 10 K of the span

Ingress protection

IP 65 per EN 60529 / IEC 60529

Standard version

Process connection

Copper alloy, lower mount (LM) or back mount (BM)

NS 63: G ¼ B (male), 14 mm flats

NS 100: G ½ B (male), 22 mm flats

Pressure element

NS 63:

Copper alloy, C-type or helical type

NS 100:

Copper alloy, C-type

Stainless steel 1.4571 or 1.4404, helical type

Movement

Copper alloy

Dial

NS 63: Plastic ABS, white, with pointer stop pin

NS 100: Aluminium, white

Black lettering

Pointer

Aluminium, black

Window

Clear non-splintering plastic

Case

Solid forged brass, with blow-out device at case circumference, 12 o'clock.

Scale ranges ≤ 0 ... 16 bar with compensating valve to vent case.

Bezel ring

Crimp ring, stainless steel

NS 63 : Natural finish

NS 100: Polished

Filling liquid

Glycerine

Options

- Other process connection
- Sealings (model 910.17, see data sheet AC 09.08)
- Internal pressure compensation (pressure compensation foil)
- Increased medium temperature up to 100 °C with special soft solder
- Ambient temperature resistant -40 ... +60 °C with silicone oil filling
- Panel or surface mounting flange
- Triangular bezel with clamp
- Centre back mount (CBM) for NS 80 with scale range ≥ 60 bar

CE conformity

Pressure equipment directive

97/23/EC, PS > 200 bar, module A, pressure accessory

Approvals

- **GL**, ships, shipbuilding (e.g. offshore), Germany
- **EAC**, import certificate, customs union Russia/Belarus/Kazakhstan
- **GOST**, metrology/measurement technology, Russia
- **CRN**, safety (e.g. electr. safety, overpressure, ...), Canada

Certificates (Option)

- 2.2 test report per EN 10204 (e.g. state-of-the-art manufacturing, material proof, indication accuracy)
- 3.1 inspection certificate per EN 10204 (e.g. indication accuracy)

Approvals and certificates, see website

Dimensions in mm

Standard version

Lower mount (LM)

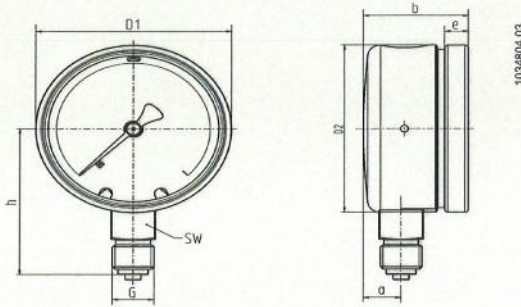

NS 63, centre back mount (CBM)

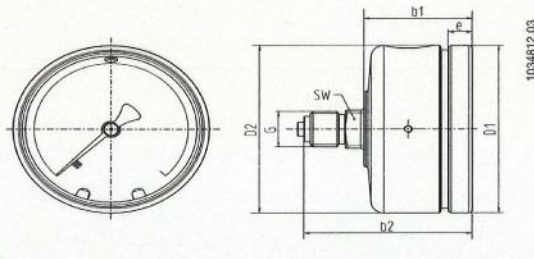

NS 80, 100, lower back mount (LBM)

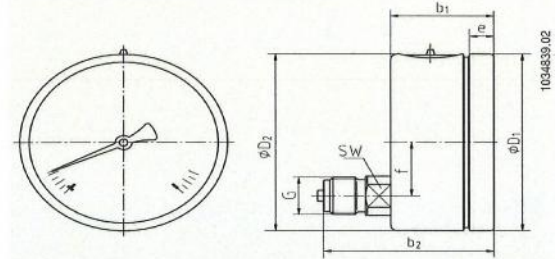

NS	Dimensions in mm											Weight in kg
	a	b	b ₁	b ₂	D ₁	D ₂	e	f	G	h ±1	SW	
63	12	36	36	56	62	62	10.5	-	G ¼ B	54	14	0.30
80	14	38.5	38.5	69.5	79	79	8.5	23	G ½ B	76	22	0.80
100	13.5	49	49	81	99	99	11.5	30	G ½ B	87	22	1.10

Process connection per EN 837-1 / 7.3

Ordering information

Model / Nominal size / Scale range / Connection size / Connection location / Options

© 2005 WIKA Alexander Wiegand SE & Co. KG, all rights reserved.
The specifications given in this document represent the state of engineering at the time of publishing.
We reserve the right to make modifications to the specifications and materials.

05/2015 EN

WIKA data sheet PM 02.06 · 05/2015

Page 3 of 3



WIKAL
WIKAL Alexander Wiegand SE & Co. KG
Alexander-Wiegand-Straße 30
63911 Klingenberg/Germany
Tel. +49 9372 132-0
Fax +49 9372 132-406
info@wika.de
www.wika.de

Art. No.	Ident No.
700	102160
700/1	102161
700/2	102162
700/3	102163
700/4	102164
700/5	102165
700/6	102166
701	102167
702	102168
703	102169
704	102170
705	102171
706	102172
707	102173
708	102174
709	102175
710	102176
711	102177
712	102178
713	102179
714	102180
715	102181
716	102182
720	102183
720/1	102184
720/2	102185
720/3	102186
720/4	102187
720/5	102188
720/6	102189
721	102190
722	102191
723	102192
724	102193
725	102194
726	102195
727	102196
728	102197
729	102198
730	102199
731	102200
732	102201
733	102202
734	102203

Art. No.	Ident No.
735	102204
736	102205
737	102206
800	102207
800/1	102208
800/2	102209
800/3	102210
800/4	102211
800/5	102212
800/6	102213
801	102214
802	102215
803	102216
804	102217
805	102218
806	102219
807	102220
808	102221
809	102222
810	102223
811	102224
812	102225
813	102226
814	102227
815	102228
816	102229
820	102230
821	102231
822	102232
823	102233
824	102234
825	102235
826	102236
827	102237
828	102238
829	102239
830	102240
831	102241
832	102242
833	102243
834	102244
835	102245

Art. No.	Ident No.
900	102246
900/1	102247
901	102248
902	102249
903	102250
904	102251
905	102252
906	102253
907	102254
908	102255
909	102256
910	102257
911	102258
950	102259
951	102260
952	102261
953	102262
954	102263
955	102264
956	102265
957	102266
958	102267
959	102268
960	102269
961	102270
962	102271
963	102272
964	102273
965	102274

Art. No.	Ident No.
1000	102275
1000/1	102276
1000/2	102277
1000/3	102278
1002	102279
1003	102280
1004	102281
1005	102282
1006	102283
1007	102284
1008	102285
1009	102286
1010	102287
1011	102288
1012	102289
1013	102290
1014	102291
1015	102292
1020	102293
1022	102294
1023	102295
1024	102296
1025	102297
1026	102298
1027	102299
1028	102300
1029	102301
1030	102302
1031	102303
1032	102304
1033	102305
1034	102306
1035	102307